

# MICRO ERASER™

## Sizing Chart Conveyor Belt Cleaning System

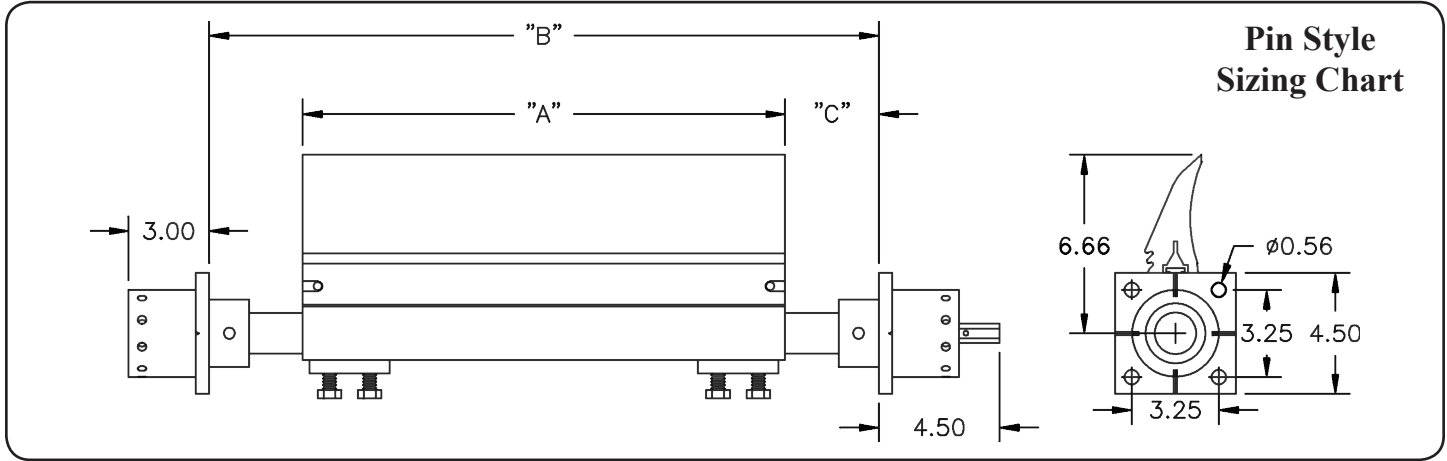

Short Tensioner (CP-MI-1350)						Standard Tensioner (CP-MI-1550)					
Part Number	A	Min. B	Max. B	Min. C	Max. C	Part Number	A	Min. B	Max. B	Min. C	Max. C
CP-MEA16X-G83	16.00	18.00	25.00	1.00	4.50	CP-MEA16M-G83	16.00	28.00	35.00	6.00	9.50
CP-MEA18X-G83	18.00	18.50	27.00	0.25	"	CP-MEA18M-G83	18.00	26.00	37.00	4.00	"
CP-MEA20X-G83	20.00	20.50	29.00	"	"	CP-MEA20M-G83	20.00	24.00	39.00	2.00	"
CP-MEA22X-G83	22.00	22.50	31.00	"	"	CP-MEA22M-G83	22.00	22.50	41.00	0.25	"
CP-MEA24X-G83	24.00	24.50	33.00	"	"	CP-MEA24M-G83	24.00	24.50	43.00	"	"
CP-MEA26X-G83	26.00	26.50	35.00	"	"	CP-MEA26M-G83	26.00	26.50	45.00	"	"
CP-MEA28X-G83	28.00	28.50	37.00	"	"	CP-MEA28M-G83	28.00	28.50	47.00	"	"
CP-MEA30X-G83	30.00	30.50	39.00	"	"	CP-MEA30M-G83	30.00	30.50	49.00	"	"
CP-MEA32X-G83	32.00	32.50	41.00	"	"	CP-MEA32M-G83	32.00	32.50	51.00	"	"
CP-MEA34X-G83	34.00	34.50	43.00	"	"	CP-MEA34M-G83	34.00	34.50	53.00	"	"
CP-MEA36Z-G83	36.00	36.50	45.00	"	"	CP-MEA36D-G83	36.00	36.50	55.00	"	"
CP-MEA38Z-G83	38.00	38.50	47.00	"	"	CP-MEA38D-G83	38.00	38.50	57.00	"	"
CP-MEA40Z-G83	40.00	40.50	49.00	"	"	CP-MEA40D-G83	40.00	40.50	59.00	"	"
CP-MEA42Z-G83	42.00	42.50	51.00	"	"	CP-MEA42D-G83	42.00	42.50	61.00	"	"
CP-MEA44Z-G83	44.00	44.50	53.00	"	"	CP-MEA44D-G83	44.00	44.50	63.00	"	"
CP-MEA46Z-G83	46.00	46.50	55.00	"	"	CP-MEA46D-G83	46.00	46.50	65.00	"	"
CP-MEA48Z-G83	48.00	48.50	57.00	"	"	CP-MEA48D-G83	48.00	48.50	67.00	"	"
CP-MEA50Z-G83	50.00	50.50	59.00	"	"	CP-MEA50D-G83	50.00	50.50	69.00	"	"
CP-MEA52Z-G83	52.00	52.50	61.00	"	"	CP-MEA52D-G83	52.00	52.50	71.00	"	"
CP-MEA54Z-G83	54.00	54.50	63.00	"	"	CP-MEA54D-G83	54.00	54.50	73.00	"	"
CP-MEA56Z-G83	56.00	56.50	65.00	"	"	CP-MEA56D-G83	56.00	56.50	75.00	"	"
CP-MEA58Z-G83	58.00	58.50	67.00	"	"	CP-MEA58D-G83	58.00	58.50	77.00	"	"
CP-MEA60Z-G83	60.00	60.50	69.00	"	"	CP-MEA60D-G83	60.00	60.50	79.00	"	"
CP-MEA62Z-G83	62.00	62.50	71.00	"	"	CP-MEA62D-G83	62.00	62.50	81.00	"	"
CP-MEA64Z-G83	64.00	64.50	73.00	"	"	CP-MEA64D-G83	64.00	64.50	83.00	"	"
CP-MEA66Z-G83	66.00	66.50	75.00	"	"	CP-MEA66D-G83	66.00	66.50	85.00	"	"
CP-MEA68Z-G83	68.00	68.50	77.00	"	"	CP-MEA68D-G83	68.00	68.50	87.00	"	"
CP-MEA70Z-G83	70.00	70.50	79.00	"	"	CP-MEA70D-G83	70.00	70.50	89.00	"	"
CP-MEA72Z-G83	72.00	72.50	81.00	"	"	CP-MEA72D-G83	72.00	72.50	91.00	"	"

**Notes:**

- To get minimum B or C, Shaft Collars must be removed and one stub end might have to be cut.
- On Short Blade/Long Frame Systems the Mainframe length must be a minimum 4" longer than the actual blade width selected.