

SUBMITTAL DATA SHEET

SPEEDY SLEEVE



SPEEDY SLEEVE CURB BOX REPAIR - SNAP IN CAP

PART NUMBER	DESCRIPTION	DIM A	DIM B	DIM C	DIM D	WT (LBS)
MP-RS-S1518W-B90	18" SLEEVE - Ø1-1/2" EXT PIPE	2-3/4"	18"	16"	7"	2.3
MP-RS-S1218W-B90	18" SLEEVE - Ø1-1/4" EXT PIPE	2-1/2"	18"	16"	7"	2.2
MP-RS-S1018W-B90	18" SLEEVE - Ø1" EXT PIPE	2-1/8"	18"	16"	7"	1.9
MP-RS-S1512W-B90	12" SLEEVE - Ø1-1/2" EXT PIPE	2-3/4"	12"	10"	5"	1.7
MP-RS-S1212W-B90	12" SLEEVE - Ø1-1/4" EXT PIPE	2-1/2"	12"	10"	5"	1.5
MP-RS-S1012W-B90	12" SLEEVE - Ø1" EXT PIPE	2-1/8"	12"	10"	5"	1.4
MP-RS-S1506W-B90	6" SLEEVE - Ø1-1/2" EXT PIPE	2-3/4"	6"	4"	3"	1.0
MP-RS-S1206W-B90	6" SLEEVE - Ø1-1/4" EXT PIPE	2-1/2"	6"	4"	3"	0.9
MP-RS-S1006W-B90	6" SLEEVE - Ø1" EXT PIPE	2-1/8"	6"	4"	3"	0.9

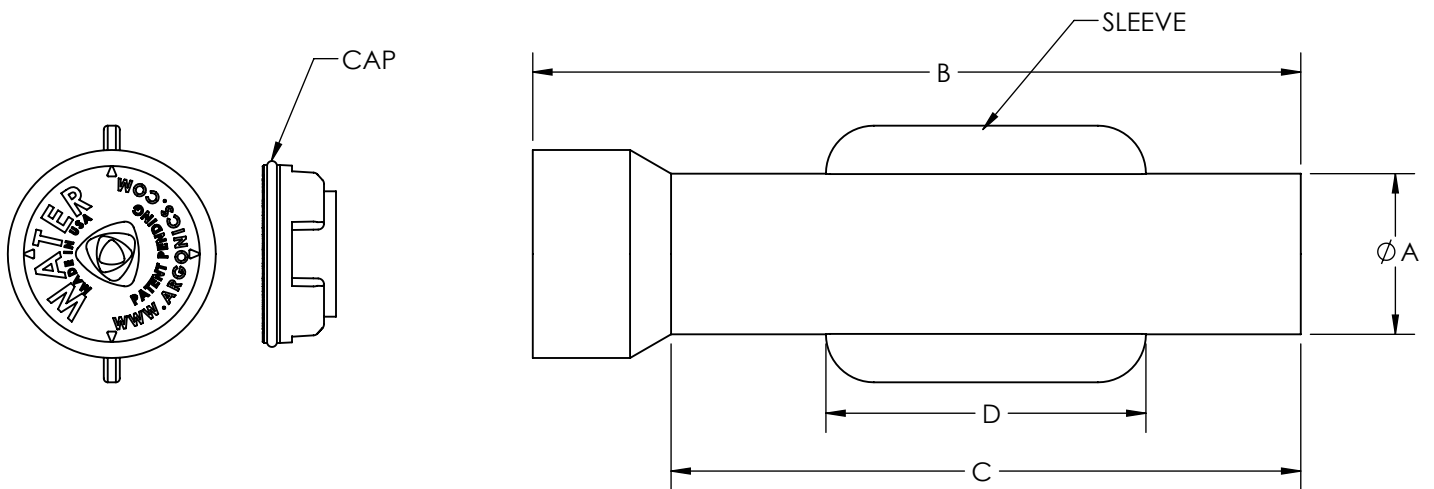

INFORMATION

- SLEEVE IS DESIGNED TO BE USED WITH STANDARD SCHUDULE 40 EXTENSION PIPE
- SLEEVE AND CAP ARE MADE OF POLYURETHANE
- CAP CONTAINS MAGNET FOR LOCATING

Argonics Inc. considers the information on this submittal sheet to be correct when published. Item and option availability, including specifications, are subject to change without notice.



ARGONICS INC.
 520 9th St. Gwinn, MI 49841
 906.226.9747 • 800.991.2746
 Fax: 906.226.9779
 www.argonics.com

Submitted By: